

Shown with TA-8 Steel Casing as example.

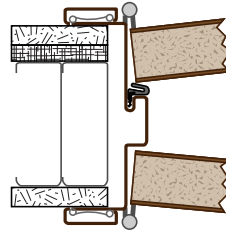

3B Jamb Hinge/Hinge - Kerfed

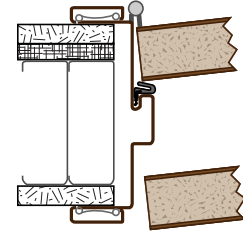

3C Jamb Hinge/Strike - Kerfed

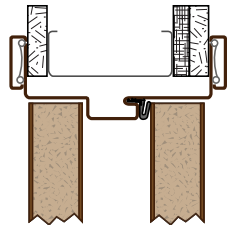
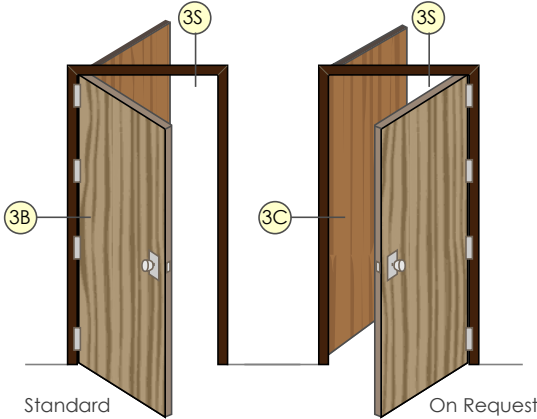

3S Header - Kerfed

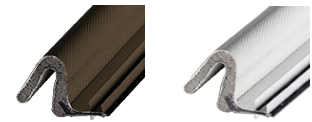

TA-46 Gasket: Weather Strip/Smoke Seal. Available in Browntone and White.

Note: Specify Color and Length.

KERFED FRAME - SINGLE COMMUNICATING

RELATED INFORMATION

FRAME MATERIALS	DOOR SIZE AND WEIGHT	JAMB DEPTH RANGES
Prefinished Steel	Max. Door Weight: 250 Lbs. each Max. Door Width: 4' - 0" Max. Door Height: 8' - 0"	Jamb Depths: 5 3/8" to 8"
DOOR THICKNESS		
1 3/4" only		
FRAME THICKNESS		
18 gauge		

All widths and heights are inside dimensions - net door or glass opening size.

FIRE RATING

JAMB DEPTH RANGE	20 MINUTE*	45, 90 MINUTE	GENERAL INFORMATION
Min. Jamb Depth: 5 3/8" Max. Jamb Depth: 8"	Max. Width: 4' - 0" Max. Height: 8' - 0"	Max. Width: 4' - 0" Max. Height: 8' - 0"	<ol style="list-style-type: none"> All openings approved for Positive and Neutral pressure unless otherwise noted. All ratings apply to steel stud, wood stud, or masonry construction. All ratings approved for category "A" and "B" doors with category "G" edge sealing. Timely's fire rated Metal "U" Insert is recommended for masonry installations. If wood sub-frame is used in place of Metal "U" Insert, it will be necessary to use fire rated drywall on both sides of wood to maintain fire rating. Wood or Aluminum casing does not affect ratings on door frames. Wood casing must be applied with hot melt glue or contact adhesive on 90 minute rated frames and on all glazed openings with 45 minute or 60 minute rating. On all other fire rated frames, wood casing can be applied with nails or finish head screws on jambs and mullions. Single frames must be prepared for strike. Embossed WHI 90 min. label is available for Primed Frames only. Metal 90 min. label riveted to frame is available.

All dimensions shown are inside dimensions - net door opening size.

* Tested and approved for Neutral Pressure only - not Positive Pressure approved.

Distributors of Timely Frames may be approved to purchase labels and apply them to frames at their own facility. Intertek has set guidelines and a fee schedule for this program. Requirements and prices are available from Timely or Intertek.

